

# Manifold Filter Kit **RMF60**

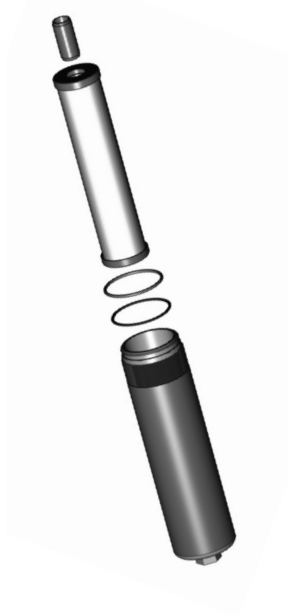

## Features and Benefits

- Allows for effective filtration in customer's manifold

**30 gpm**  
**115 L/min**  
**6000 psi**  
**415 bar**

NF30  
NFS30  
YF30  
DF40  
CF40  
CFX30  
RF60  
RFS50  
CF60  
VF60



INDUSTRIAL



AUTOMOTIVE  
MANUFACTURING



MACHINE  
TOOL



STEEL  
MAKING



PAPER  
INDUSTRY



AGRICULTURE



MOBILE  
VEHICLES

## Applications

KF30  
TF50  
KF50  
KC50  
KFH50  
MKF50  
KC65

FOF60-03

NOF30-05

NOF50-760

NMF30

**RMF60**

Cartridge  
Elements

Flow Rating:	Up to 30 gpm (115 L/min) for 150 SUS (32 cSt) fluids
Max. Operating Pressure:	6000 psi (415 bar)*
Min. Yield Pressure:	18,000 psi (1240 bar)*
Rated Fatigue Pressure:	2300 psi (159 bar)*
Temp. Range:	-20°F to 225°F (-29°C to 107°C)
Element Case:	Steel
Element Change Clearance:	3.0" (75 mm)

\*Only with manifold material properties equivalent to AISI 1018 C.R.S.

## Filter Housing Specifications

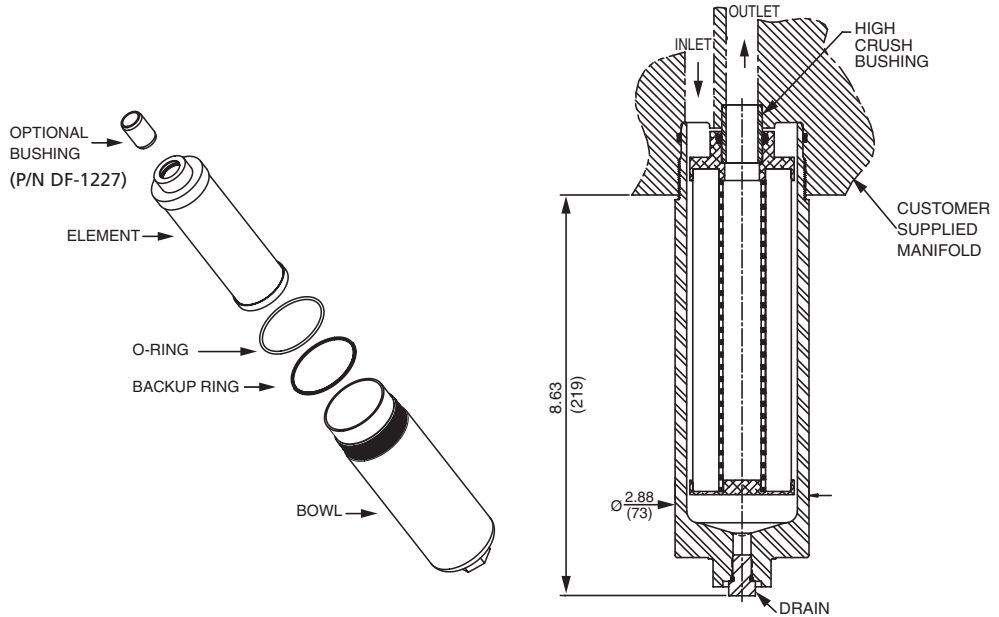

Manifold kit consists of element, o-ring, backup ring and bowl. Bushing is optional depending on machined cavity style. For manifold machining details, request drawing D-10536 from factory.

Metric dimensions in ( ).

## Element Performance Information

Element	Filtration Ratio Per ISO 4572 / NFPA T3.10.8.8 Using automated particle counter (APC) calibrated per ISO 4402			Filtration Ratio wrt ISO 16889 Using APC calibrated per ISO 11171		Dirt Holding Capacity gm
	$\beta_x \geq 75$	$\beta_x \geq 100$	$\beta_x \geq 200$	$\beta_{x(c)} \geq 200$	$\beta_{x(c)} \geq 1000$	
8RZX3	<1.0	<1.0	<2.0	4.7	5.8	N/A
8RZX10	7.4	8.2	10.0	8.0	9.8	N/A
8RZX25						

Element Collapse Rating: 3000 psid (210 bar)

Flow Direction: Outside In

Element Nominal Dimensions: 2.18" (55 mm) O.D. x 8.15" (206 mm) long

## Pressure Drop Information

Based on Flow Rate and Viscosity

$\Delta P_{\text{element}}$

$\Delta P_{\text{element}} = \text{flow} \times \text{element } \Delta P \text{ factor} \times \text{viscosity factor}$

El.  $\Delta P$  factors @ 150 SUS (32 cSt):

8RZX3 N/A  
8RZX10 N/A

If working in units of bars & L/min, divide above factor by 54.9.

Viscosity factor: Divide viscosity by 150 SUS (32 cSt).

## Filter Model Number Selection

### How to Build a Valid Model Number for a Schroeder RMF60:



Example: NOTE: One option per box

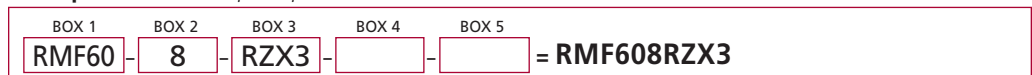

BOX 1	BOX 2	BOX 3	BOX 4	BOX 5
Filter Series	Element Length	Element Size and Media	Seal Material	Bushing
RMF60	8	RZX3 = E size 3 $\mu$ Excellement® Z media (high collapse center tube) RZX10 = E size 10 $\mu$ Excellement Z media (high collapse center tube) RZX25 = E size 25 $\mu$ Excellement Z media (high collapse center tube)	Omit = Buna N V = Viton® H = EPR	Omit = Included N = Not included

### NOTES:

Box 2: Replacement element part numbers are a combination of Boxes 2, 3, and 4.  
Example: 8RZX3V

Box 4: Viton is a registered trademark of DuPont Dow Elastomers.